

KIT AUTO

INSTALLATION, USE AND MAINTENANCE MANUAL

GB

Dear Customer, congratulations on choosing this Made in Italy ATLAS FILTRI product.

Please carefully read and keep this document that will help you best enjoy and use all our products. Continue to prefer us and beware of imitations.

KIT AUTO is suitable to the HYDRA self cleaning filters series and to the filters series with discharge system PLUS S 3P BX and CX, DP S and DP S DS, K PLUS S 3P and K DP S.

SOLENOID VALVE CONNECTIONS

- Screw in the nipple with O-ring on the bottom of the cup.
- Screw in the solenoid valve, being careful that the flow direction arrow faces down.
- Screw the drain funnel or hose fitting onto the solenoid valve.
- Connect the programmer connector to the specific solenoid valve housing.

At the start the timer shows "rEL" followed by the version number (100), then the timer goes into "Working Mode" indicated by the flowing lines in a circle on the display.

1 Programming mode of the interval between two successive washes(in hours):

From "Working Mode" press the button SET, the display shows the symbol H followed by a number that indicates the interval between two washes. Then press the MANUAL button to modify the number using the SET button to decrease and the MANUAL button to increase the interval from a minimum of 2 hours and a maximum of 99 hours. To confirm the currently selected interval do not touch any button for at least 3 seconds.

To come back into "Working Mode" do not touch any button for at least 10 seconds.

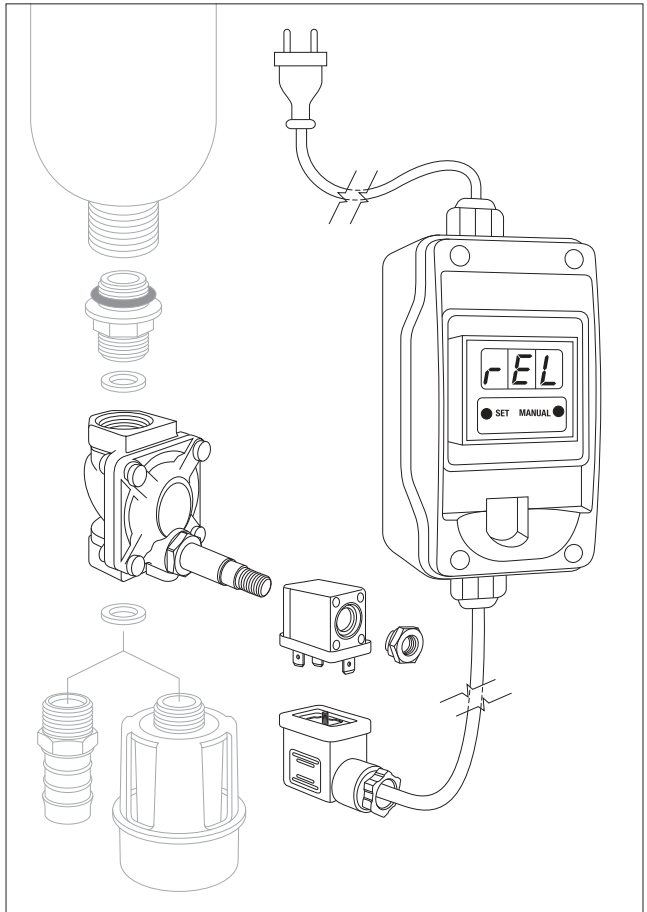

Manufacturer's identification: ATLAS FILTRI s.r.l.

Headquarter: via PieroBon, 32 | Production site: via del Santo, 227

I-35010 Limena, Italy - Tel. +39.049.76.90.55 Fax +39.049.76.99.94

www.atlasfiltri.com



COMPANY WITH
MANAGEMENT SYSTEM
CERTIFIED BY DNV GL
= ISO 9001 =
= ISO 14001 =
= OHSAS 18001 =

2 Programming mode of the duration (in seconds) of the backwash (exhaust valve opening):

From "Working Mode" press for two consecutive times the button SET, the display shows the symbol " " followed by a number that indicate the duration of exhaust valve opening. Then press the MANUAL button to modify the number using the SET button to decrease and the MANUAL button to increase the interval from a minimum of 2 seconds and a maximum of 99 seconds. To confirm the currently selected interval do not touch any button for at least 3 seconds.

To come back into "Working Mode" do not touch any button for at least 10 seconds.

3 Manual opening of the exhaust valve

From "Working Mode", press the button MANUAL, the valve opens for the time set in step 2. When the valve is open on the screen appears "FLH". After the valve closing the display shows "ATT" for 60 seconds, during this time the manual opening can not be operated. At the end of the 60 seconds the device comes back on "Working Mode".

WARNINGS

The pin type adapter must be inserted in a standard socket, equipped with ground contact and protected by a circuit breaker. Make sure the adapter is firmly inserted in the socket and located in a protected area, away from accidental contacts, water sprays, humidity and heat sources.

WARNING: the programmer must be set with dry hands and appropriate tools.

HYDRAULIC CHECKS AND START-UP

Proceed as follows after filter drain installation and connection:

- Make sure there are no water leaks by gradually opening water supply to the filter;
- Make sure the system is correctly positioned to facilitate routine maintenance operations;
- Make sure sampling faucets are installed before and after the device;
- Make sure the drain pipe is firmly secured and that no water leaks during filter cleaning;
- Check whether any flood protection devices are needed, installed and efficient;
- Check whether an adequately dimensioned drain is installed and periodically check for clogs;
- Check system correspondence with any local standards or recommendations;
- Gradually fill the filter 3/4 full and release air in the filter.

PROBLEM	CAUSE	SOLUTIONS
Water leaks between the cup and solenoid valve	- nipple o-ring worn.	- replace the o-ring.
Water leaks at drain	- build-up in the solenoid valve body.	- manual clean once or several times.
After the connecting to power supply the display does not turn on.	- the plug is not fully inserted; - the programming panel is broken.	- check if correctly inserted; - contact the dealer.



DECLARATION OF COMPLIANCE

Manufacturer's address: ATLAS FILTRI srl - Via del Santo 227, 35010 Limena (PD) - ITALY

HYDRA AUTO filters are constructed in accordance with the following European directives:

N° 2004/108/EC - Electromagnetic compatibility.

N° 2006/95/EC - Low voltage directive.

UNI EN 1717 - Protection against pollution of potable water in water installations and general requirements of devices to prevent pollution by backflow.

Specifically, the following harmonised regulations were applied:

EN 50081-1, EN 55014, EN 60800-2, EN 61000-4-4, EN 61000-3-2, EN 61000-3-3, EN 55104, EN 60204-1.